

24/7 HIGH INTENSITY USE CHAIR

OPERATING INSTRUCTIONS



FEATURES

- **PNEUMATIC SEAT HEIGHT ADJUSTMENT**
To raise seat height, remove pressure from seat and lift lever (1) up. To lower seat height, sit on chair and lift lever (1) up.
- **TILT TENSION ADJUSTMENT**
To adjust title tension, turn knob (4) clockwise to increase tension and counter-clockwise to decrease or ease the tension.
NOTE: Be careful not to completely loosen knob (4).
- **BACK TILT ANGLE ADJUSTMENT**
To adjust the back tilt angle, apply pressure to backrest and pull lever (3) out for free float. To lock backrest into position push lever (3) in.
- **SEAT SLIDER ADJUSTMENT**
To slide seat forward or backward, pull lever (2) out. Release lever (2) to lock desired seat position.
- **ARM HEIGHT ADJUSTMENT**
To adjust arm height, push button (5) to allow the arms to move up or down freely. Release button (5) once the desired height is reached.

WARNING

1. Use this product only one person at a time.
2. Do not use this chair unless all bolts screws and knobs are securely tightened.
3. Check that all bolts screws and knobs are tight every three months or as needed.
4. Do not overturn back tilt knob when decreasing tension.
5. Dispose of packing material properly. Do not use plastic cover as head covering. It may cause suffocation.
6. Do not use chair as a stepladder.
7. Use this chair for its intended purpose only.
8. Use mild detergent only for cleaning.

LIMITED WARRANTY

24/7 ELITE™ chairs are warranted* from the date of purchase against failure due to material and workmanship as follows:

- 5 Years on component parts including pneumatic cylinder, control mechanism, base and casters.
- 2 Years on upholstery fabric and foam against wear and deterioration.

To make a warranty claim, contact Parts Department. Provide model number and description of the problem and obtain return authorization.

At it's option Office Star Products will:

- (a) Supply compatible components of current manufacture.
 - (b) Repair the customer's component. The customer must prepay freight on any components returned to the factory.
- Return freight on components still in warranty will be paid by Office Star Products.

**All warranties are limited to the original purchaser for normal commercial usage defined as a standard forty hour work week by persons weighing 300 lbs. or less. This warranty will not cover labor, freight or damage from misuse, abuse, negligence, alteration, accident, vandalism, rusting, acts of nature or any other event beyond the control of Office Star Products. The warranty does not cover cosmetic damage that may result from normal use. Liability for incidental or consequential damages is excluded. The user assumes all risk of injury resulting from use of this product. This warranty gives you specific legal rights, and you may also have other rights which vary from state to state.*

Our quality standards are among the highest in the industry. Sometimes, no matter how hard we try, there are times when parts are damaged or missing. Our Parts Department will do everything possible to promptly remedy the problem. Contact us via e-mail parts@officestar.net, by Fax 1-909-930-5629, or toll free parts number 1-800-950-7262, Monday through Friday 8:00 a.m. - 5:00 p.m. Pacific Time.

54666

24/7 HIGH INTENSITY USE CHAIR

ASSEMBLY INSTRUCTIONS

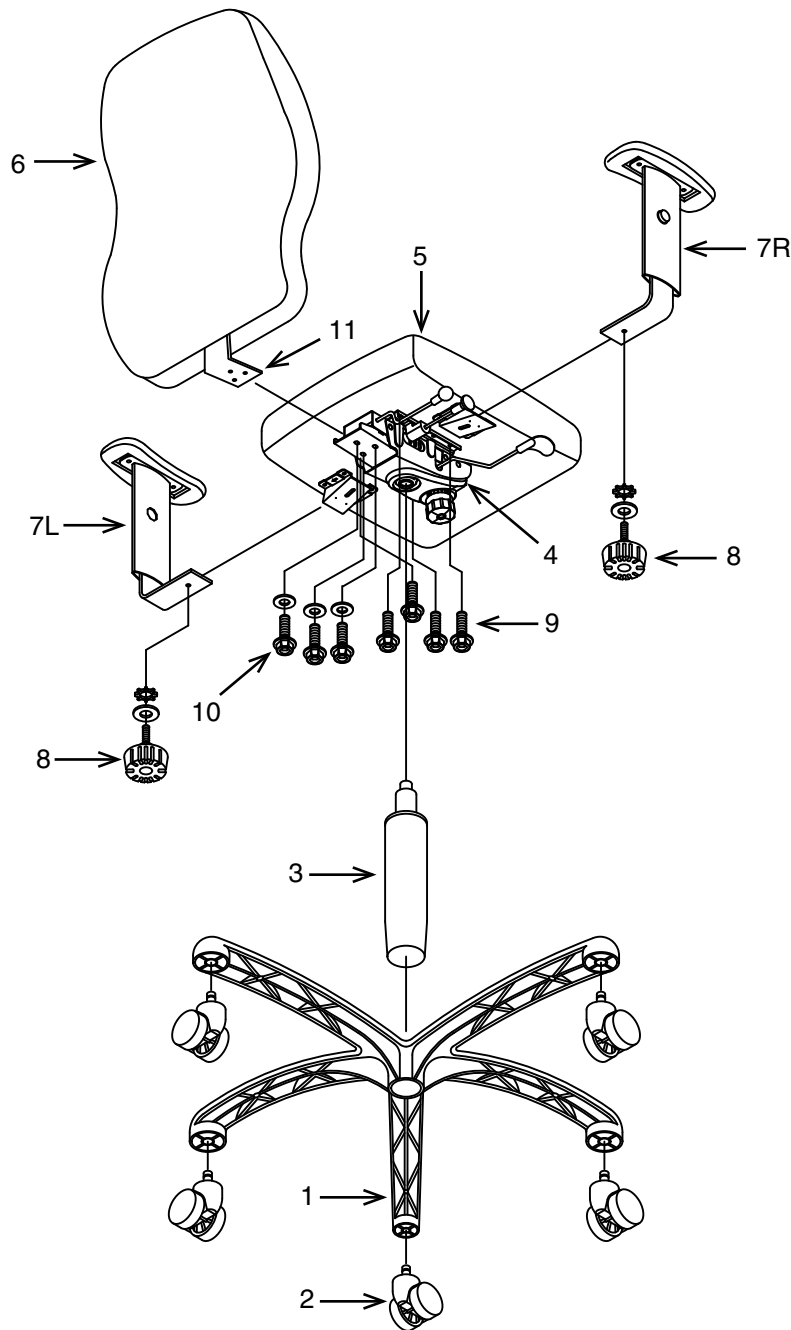

PART	QTY
1. Base	1
2. Caster	5
3. Pneumatic Cylinder	1
4. Mechanism	1
5. Seat Cushion	1
6. Back Cushion	1
7. Arms (7L & 7R)	2
8. Arm Knob w/ Washer	2
9. Mechanism Screw	4
10. Back Support Screw w/ Washer	3
11. Back Support (pre-installed)	1
12. Allen Wrench	1

Remove all the parts from carton, separate them into part numbers indicated on the list and make sure part quantities are correct.

STEP 1 Insert five Casters (2) into Base (1), push hard until you hear or feel Caster (2) snap into place. Insert Pneumatic Cylinder (3) into Base (1).

STEP 2 Attach Arms (7L & 7R) to Seat Cushion (5) using one Arm Knob w/ Washer (8) for each Arm (7). **FULLY TIGHTEN ARM KNOBS w/ WASHER (8).**

STEP 3 Attach Mechanism (4) to Seat Cushion (5) using four Mechanism Screws (9). **FULLY TIGHTEN ALL MECHANISM SCREWS (9).**

STEP 4 Attach Back Support (11) to rear of Mechanism (4) using three Back Support Screws w/ Washers (10). **FULLY TIGHTEN BACK SUPPORT SCREWS w/ WASHERS (10).**

STEP 5 Place the assembled seat on top of Pneumatic Cylinder (3) and apply pressure.

ATTENTION: MAKE SURE ALL SCREWS ARE FULLY TIGHTENED BEFORE USING CHAIR.